

ARRA STREET OVERLAY

-  FEDERAL STIMULUS OVERLAY REPAIR
-  TRANSIT CENTER

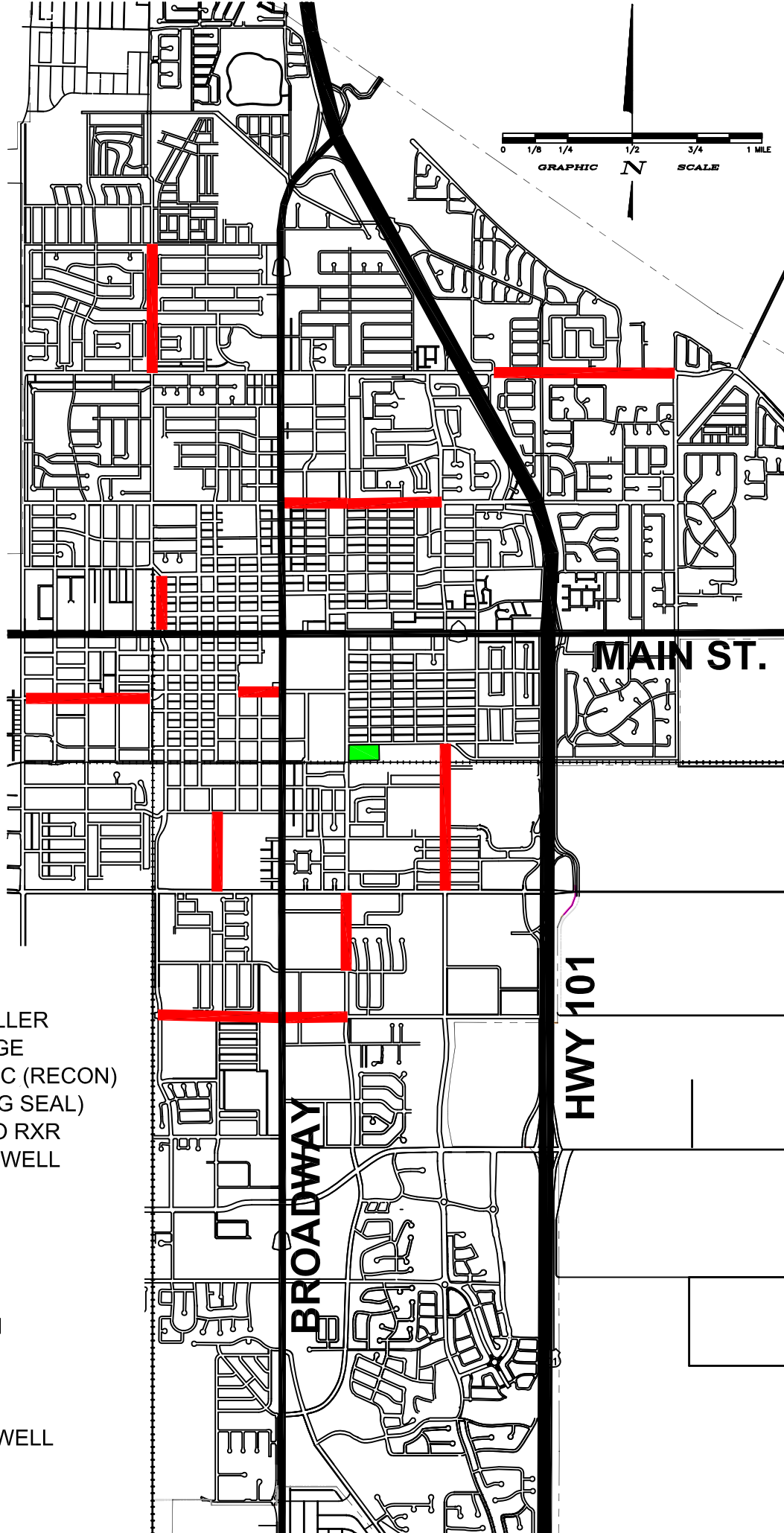

STREET ASPHALT PROJECT 1

- DONOVAN - CARLOTTI TO SUEY
- ALVIN - BROADWAY TO NORTH MILLER
- ALVIN - MILLER TO NORTH COLLEGE
- MAIN - LANDFILL GATE TO PHILBRIC (RECON)
- PHILBRIC - MAIN TO STOWELL (FOG SEAL)
- BLACK - TREATMENT PLANT P/L TO RXR
- THORNBURG - MORRISON TO STOWELL
- BATTLES - RXR TO BROADWAY
- BATTLES - BROADWAY TO MILLER

STREET ASPHALT PROJECT 2

- RAILROAD - TAYLOR TO DONOVAN
- WESTERN - FESLER TO MAIN
- COOK - BLOSSER TO RAILROAD
- COOK - PINE TO BROADWAY
- COLLEGE DRIVE - BOONE TO STOWELL
- MILLER - ENOS TO STOWELL
- MILLER - INGER TO BETTERAVIA